



## The CLA lubrication system from iwis

Correct relubrication **reduces chain wear** and considerably extends the **service life** of a chain: More than two thirds of all chain failures can be avoided with proper relubrication!

**Economical, clean and highly efficient:** The new iwis CLA minimum quantity lubrication system employs a special applicator to precisely dose small quantities of lubricant onto the chain. The compact pump can be controlled using either a PLC or a manual timer switch, which makes it an ideal candidate for integration into both new and existing systems.

The highly efficient iwis CLA lubrication system is one of the **most sustainable chain lubrication systems** on the market!

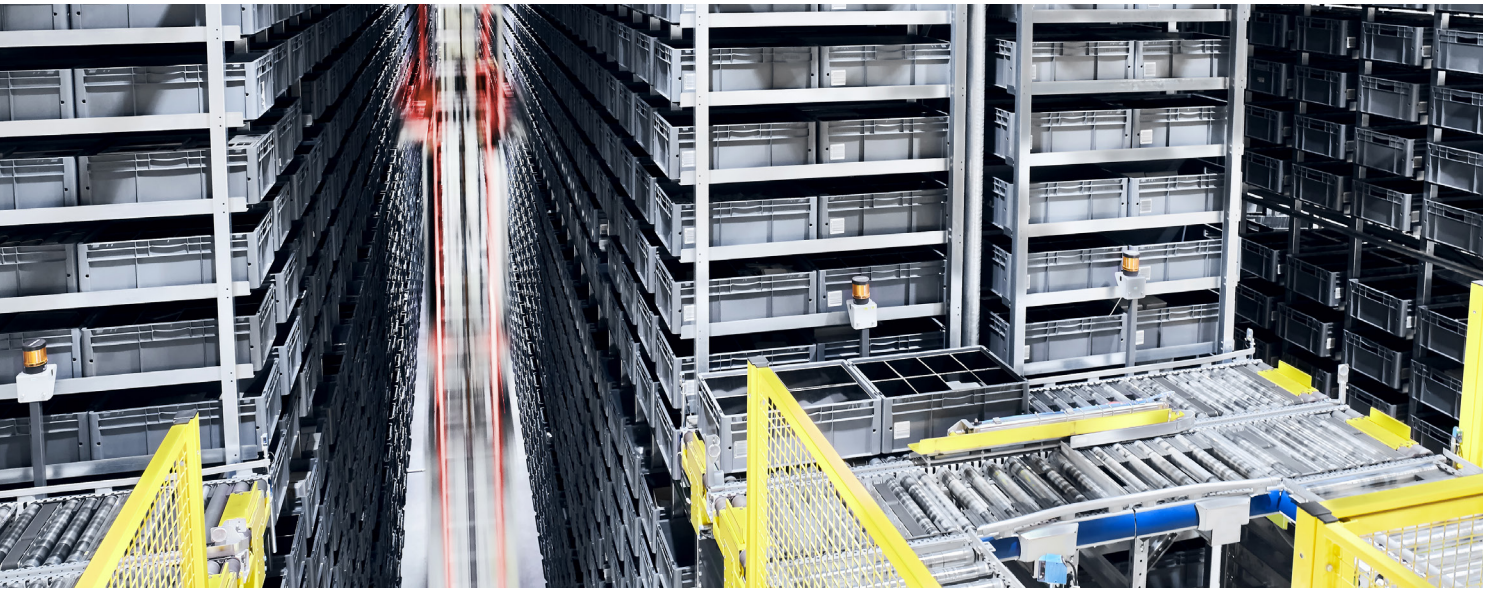

## Chain Lubrication Application (CLA)

iwis's new, fully automatic CLA lubrication system for chain drives acts as a highly efficient **minimum quantity lubrication system**. The applicator, which is made from an **extremely resistant material**, acts as a reservoir via which small quantities of lubricant are continuously delivered to the chain at the precise locations where it is actually needed. This prevents the operating chain from sometimes not being supplied with enough lubricant and also prevents unnecessarily large volumes of oil from being dispensed onto the chain and its environment.

The applicators are available in standard dimensions as well as in custom variants.

### Highlights of the CLA lubrication system

- Clean, precise minimum quantity lubrication
- Resilient, long-life applicators
- Lubricant is dosed to the applicators at regular intervals. Here, it is buffered and constantly applied to the chain in small quantities
- Economical dosing saves valuable lubricant and protects the environment
- High-performance lubricants for long-lasting lubrication and low consumption
- Simple to install and take into operation
- Can be retrofitted to existing systems easily

The CLA pumps can be operated using time control (TC version) or can be simply integrated in the machine's PLC (PC version).

The **compact size** simplifies the task of retrofitting the device in existing plant and machinery. Thanks to a pump pressure of **up to 70 bar**, the distributors are able to supply up to **16 lubrication points** with lubricant. With the aid of the capillary effect, the lubricant is cleanly being delivered to the chain.

### Highlights of the CLA compact pump

- Compact and powerful with max. 70 bar pump pressure
- Capacity of 400 ml lubricant oil
- Simple and fast to refill with oil
- Error messages issued when lubrication is interrupted: Filling level empty, hydraulic overload due to blocked hoses etc. and over- or undervoltage in the unit
- Remote status monitoring possible

### Safe operation for people, machines and chains:

- Hoses are not constantly pressurized, so no risk of injury from damaged hoses
- Lubricant empty: Pump reports low oil level
- Overload: Excessive back pressure is detected, for instance if a hose is kinked
- Status messages on operating the pump are displayed directly on the pump (TC version) or reported to the PLC (PC version)

Fill in our CLA project planning form and you will receive a chain relubrication system that is tailored to your application!



## Simplex CLA applicator with straight axis

### Dimensions

Designation	b1 mm	d1 mm	d2 mm	d3 mm	b mm	b3 mm	b4 mm	g1	g2	SW mm	z
CLA applicator 08A/B-1 pinion M10 z12	29	53	49.1	39	71.2	5	30.0	M6	M10	15	12
CLA applicator 10A/B-1 pinion M10 z10	29	55	51.4	39	71.2	5	30.0	M6	M10	15	10
CLA applicator 12A/B-1 pinion M10 z8	29	55	49.8	36	71.2	5	30.0	M6	M10	15	8
CLA applicator 16A/B-1 pinion M10 z8	40	75	66.4	48	81.2	10	30.0	M6	M10	15	8
CLA applicator 20A/B-1 pinion M16 z8	50	90	83.0	59	116.4	10	49.1	M10x1	M16	24	8
CLA applicator 24A/B-1 pinion M16 z10	60	138	123.3	93	126.4	20	49.1	M10x1	M16	24	10
CLA applicator 28A/B-1 pinion M16 z8	80	140	116.2	81	146.4	20	49.1	M10x1	M16	24	8
CLA applicator 32A/B-1 pinion M16 z8	80	150	132.8	93	146.4	20	49.1	M10x1	M16	24	8

## Duplex CLA applicator with straight axis

### Dimensions

Designation	b1 mm	d1 mm	d2 mm	d3 mm	b mm	b3 mm	b4 mm	g1	g2	h mm	SW mm	z
CLA applicator 08A/B-2 pinion M10 z12	40	53	49.1	39	81.2	5	30.0	M6	M10	15	15	12
CLA applicator 10A/B-2 pinion M10 z10	40	55	51.4	39	81.2	5	30.0	M6	M10	15	15	10
CLA applicator 12A/B-2 pinion M10 z8	44	55	49.8	36	86.2	5	30.0	M6	M10	15	15	8
CLA applicator 16A/B-2 pinion M16 z8	80	75	66.4	48	146.4	10	49.1	M10x1	M16	30	24	8
CLA applicator 20A/B-2 pinion M16 z8	80	90	83.0	59	146.4	10	49.1	M10x1	M16	30	24	8
CLA applicator 24A/B-2 pinion M16 z10	100	138	123.3	93	166.4	10	49.1	M10x1	M16	50	24	10
CLA applicator 28A/B-2 pinion M16 z8	130	140	116.2	81	196.4	10	49.1	M10x1	M16	70	24	8
CLA applicator 32A/B-2 pinion M16 z8	130	150	132.8	93	196.4	10	49.1	M10x1	M16	70	24	8

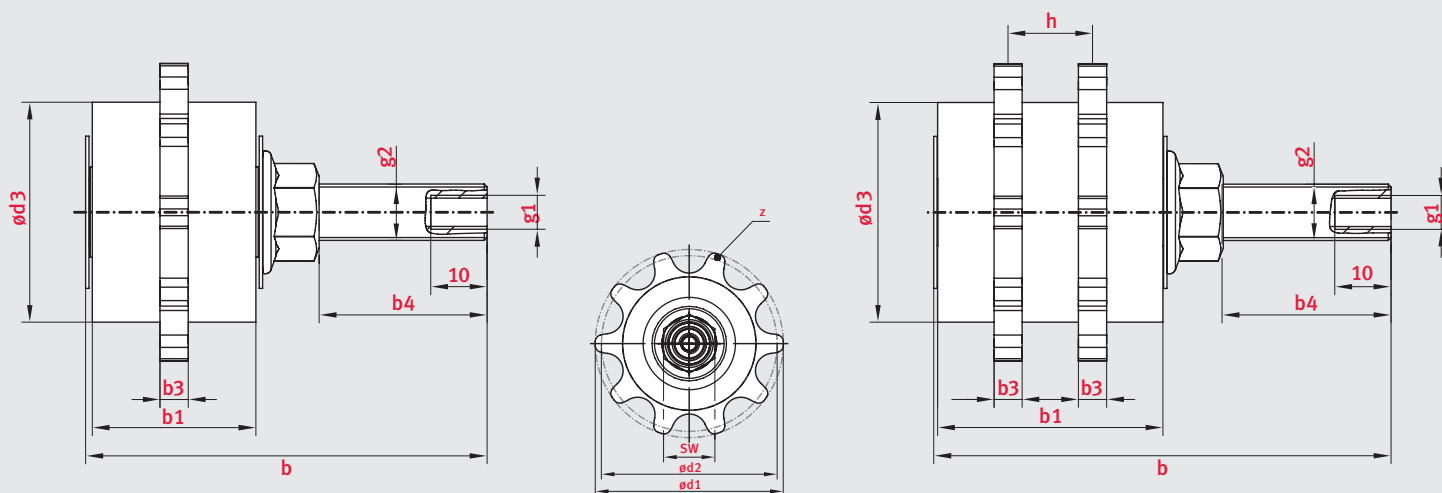

Applicators for triplex chains and a wide range of special designs for special chains available on request.  
To connect the applicator, you will need a hose connector (thread size g1).

**CLA applicator roller on steel spring sheet**  
For special size chains or for slow to medium speeds.

Designation	<b>b</b> mm	<b>b1</b> mm	<b>d1</b> mm	<b>t*</b> mm	<b>Hose connector</b>
CLA applicator roller D40 B20 steel spring sheet	51.4	20	40	0.8	M10x1
CLA applicator roller D40 B24 steel spring sheet	55.4	24	40	0.8	M10x1
CLA applicator roller D40 B30 steel spring sheet	61.4	30	40	0.8	M10x1
CLA applicator roller D40 B40 steel spring sheet	71.4	40	40	0.8	M10x1
CLA applicator roller D40 B45 steel spring sheet	76.4	45	40	0.8	M10x1
CLA applicator roller D65 B50 steel spring sheet	81.4	50	65	0.8	M10x1

\* steel spring sheet thickness

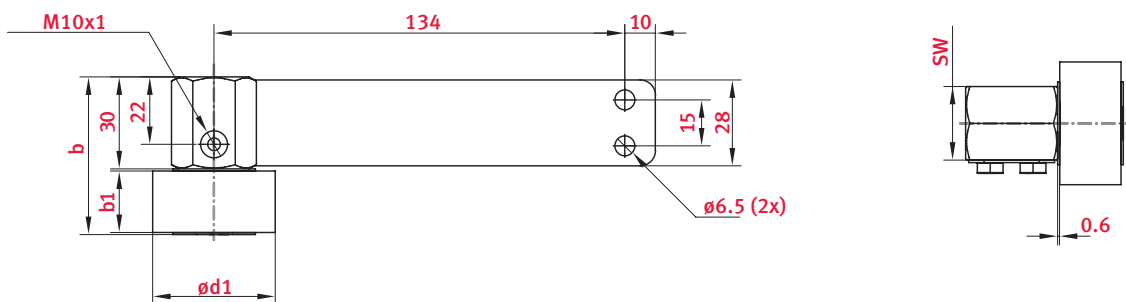

**Matching hose connector M6**  
(for straight axis only, thread size g1)

Designation	Item number
CLA tube connector, straight M6	<b>40012136</b>
CLA tube connector, 90° M6	<b>40012139</b>

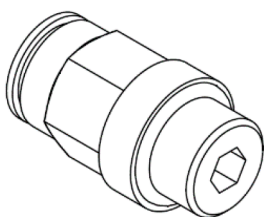

CLA hose connector, straight

**Matching hose connectors M10x1**

Designation	Item number
CLA tube connector, straight M10x1	<b>40012138</b>
CLA tube connector, 90° M10x1	<b>40012141</b>

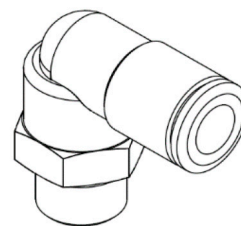

CLA hose connector, 90°



## CLA accessories – the right lubrication system matched to your individual needs

In addition to the CLA pump, iwis also supplies the corresponding **connecting elements** and **hoses** to form a set that is perfectly matched to the application in question. A number of suitable **splitters** and **progressive distributors** of different designs are available to allow lubrication of multiple locations. Contact us to support you in designing and dimensioning your ideal system.

## CLA high-performance lubricants

Two lubricants – ideal for use with the iwis CLA lubrication system and perfectly suited for the relubrication of chains. Optimum penetration behaviour and effective protection against wear for a long service life of the chains.

### iwis CLA Oil HP

- High-performance oil with PTFE for outstanding wear and corrosion protection properties
- Highly effective additives for outstanding flow properties combined with high adhesion due to its high viscosity
- Ideally suited even for fast-running chain drives

Colour	White
Viscosity at 40 °C	2,500 mm <sup>2</sup> /s
Density at +15 °C	0.92 g/cm <sup>3</sup>
Temperature range	-10 °C to +80 °C
Container	5-litre cannister

### iwis CLA Oil Food

- Low-viscosity, high-performance lubricant offering outstanding wear protection with NSF-H1 food grade approval
- Carefully selected additives allow the lubricant to penetrate perfectly into the chain joints
- The extremely resistant, high-adhesion lubricant also has excellent noise-reducing properties

Colour	Yellowish, clear
Viscosity at 40 °C	141 mm <sup>2</sup> /s
Density at +15 °C	0.867 g/cm <sup>3</sup>
Temperature range	15 °C to + 120 °C
Container	5-litre cannister



## Project planning form for the CLA lubrication system

We would be happy to help you choose the right pump and accessories for your application:

### Details about the field of application

What application and sector is the lubrication system to be used in?

What are the ambient conditions? (temperature, contact with external agents, outdoor ...)

### Details about the chain

Type, pitch, strands and width (e.g. roller chain 16B-2 w=68 mm, accumulating chain M127 SFS w=11 mm ...)

Does the chain have attachments?  Yes  No

### Details about the chain drive

Chain speeds (m/s):

Special considerations (axis alignment, cyclical or reversible operation, prolonged idle times ...)

Construction of the chain drive (axis offsets, deflections). Diagrams/drawings

Number of chains and (total) length of each

Number and positions of current lubrication points (if known)

Lengths of the lines from the pump to each lubrication position (please consult us in the case of lengths >25 m per line)

### Details about the iwis CLA lubrication pump and the lubricant

Is a specific lubricant to be used? If so, which one?

(Warning! Checking for compatibility may take some time)

Pump control?  Time-controlled or  Pulse-controlled (PLC integration)

## Our subsidiaries

### Germany

iwis antriebssysteme GmbH & Co. KG  
Albert-Roßhaupter-Straße 53  
81369 München  
Tel. +49 89 76909-1500  
Fax +49 89 76909-1198  
sales-muenchen@iwis.com

### Germany

iwis antriebssysteme GmbH  
Essener Straße 23  
57234 Wilnsdorf  
Tel. +49 2739 86-0  
Fax +49 2739 86-22  
sales-wilnsdorf@iwis.com

### Germany

iwis agrisystems  
Schützenweg 5  
36205 Sontra  
Tel. +49 5653 9778-0  
Fax +49 5653 9778-26  
agrisystems@iwis.com

### Brazil

iwis Sistemas de Transmissão  
de Energia Mecânica Ltda.  
Rua Bento Rosa, nº 1816  
Bairro Hidráulica  
95.900-000 Lajeado, RS  
Tel. +55 51 3748-7402  
salesbrazil@iwis.com

### China

iwis drive systems (Suzhou) Co., Ltd.  
No. 266 LvliangShan Road  
215153 Suzhou SND  
Tel. +86 512 8566-3010  
Fax +86 512 8566-3009  
salescn@iwis.com

### France

iwis systèmes de transmission  
10, rue du Luxembourg  
69330 Meyzieu  
Tel. +33 4374515-70  
Fax +33 4374515-71  
salesfr@iwis.com

### Great Britain

iwis drive systems Ltd.  
Unit 8c Bloomfield Park  
Bloomfield Road, Tipton  
West Midlands, DY4 9AP  
Tel. +44 12 15213600  
Fax +44 12 15200822  
salesuk@iwis.com

### India

iwis drive systems India Pvt. Ltd.  
„Anisha“, Unit No3, SR. No. 84/1  
Regency Cosmos, Baner Mahalunge Road,  
Opposite to Amruta Hotel  
Baner, Pune, Maharashtra-411045  
Tel. +91 20 67110305  
salesin@iwis.com

### Italy

iwis drive systems Srl  
Via Carlo Rota, 10  
20090 Monza (MB)  
Tel. +39 340 9296142  
Fax +49 89 7690949-1726  
italia@iwis.com

### Canada

iwis drive systems, Inc.  
101-19097, 26th Avenue,  
Surrey BC V3Z 3V7  
Tel. +1 604 560-6395  
Fax +1 604 560-6397  
salesca@iwisusa.com

### South Korea

iwis engine systems Korea Co., Ltd.  
Office No. 403-2, 322 Yanghyeon-ro  
(Yatap-dong, Korea Design Center)  
Bundang-Gu, Seongnam Si,  
Gyeonggi-Do, Korea (ZIP) 13496  
Tel. +82 31 788-7545  
saleskor@iwis.com

### Switzerland

iwis AG Kettentechnik  
Bahnweg 4 (Postfach)  
5504 Othmarsingen  
Tel. +41 62 8898999  
Fax +41 62 8898990  
info@iwis-ketten.ch

### South Africa

iwis drive systems, (Pty) Ltd.  
Unit 3, 127 Koornhof Road  
Meadowdale, 1613  
Tel. +27 11 392-2306  
Fax +27 11 392-3295  
salessa@iwis.com

### Czechia

iwis antriebssysteme spol. s r.o.  
Přísecká 893  
38601 Strakonice  
Tel. +420 383 411811  
Fax +420 383 321695  
salescz@iwis.com

### Turkey

iwis tahrik sistemleri ltd. şti.  
Kağıthane Ofis Park 4C-Blok  
Bağlar Cad. No: 14  
34406 Kağıthane-Istanbul  
Tel. +90 212 939-3843  
Fax +90 212 939-3701  
salestr@iwis.com

### USA

iwis drive systems, LLC  
Building 100, 8266 Zionsville Road  
Indianapolis, IN 46268  
Tel. +1 317 821-3539  
Fax +1 317 821-3569  
sales-us@iwis.com