



For your
information

Precision chains from the low-maintenance **SL Series** Super Longlife Technology

iwis precision chains from the **SL Series** (Super Longlife) enjoy an **optimal service life** because they combine **extreme wear resistance, highly even running, unmatched precision** and **significantly higher breaking forces and fatigue strength** than the relevant standard requires.

Super Longlife Technology was specially developed by iwis **for the extreme loads** found in **timing drives** and **industrial applications**. Added value for your application, offered exclusively by iwis.

iwis SL chains have the following special characteristics:

- All pins undergo surface treatment to optimise their wear resistance
- **SL** pins therefore have an extremely hard surface and require little maintenance
- **SL** roller chains are highly impact-resistant
- Highest wear resistance
- Longer service life
- Consistently reliable high breaking force and fatigue strength
- Dry running capabilities mean lower sensitivity to insufficient lubrication
- Less susceptible to corrosion and formation of fretting corrosion in link joints
- All iwis chains are subjected to optimum pre-stretching and treated with high-performance initial lubricant

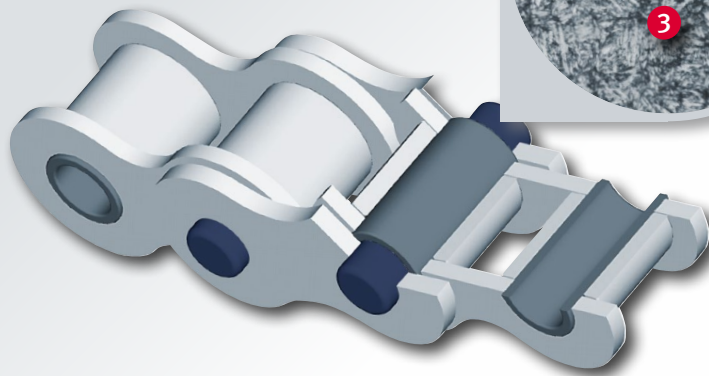
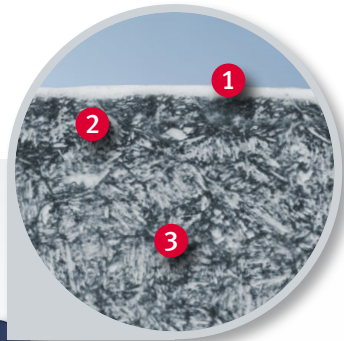

Cross-section of an SL pin

- ❶ Peripheral layer with very high surface hardness
- ❷ Diffusion zone: a hard, load-bearing high-stability layer which, together with the peripheral layer, provides wear resistance.
- ❸ Base material: ductile core of the pin.

Product range SL chains (standard)

ISO	iwis reference	Trade name Pitch x inner width	Pitch p (mm)	Tensile strength F_b				Weight per m q (kg/m)	Inner link			Outer link		Pin d_1 (mm) max.	Transverse pitch e (mm)
				iwis (N) ave.	Norm (N) min.	Bearing area f (cm ²)	b_1 (mm) min.		b_2 (mm) max.	g (mm) max.	a_1 (mm) max. 2)	a (mm) max. 2)	Roller d_2 (mm) max.		
Simplex															
08 B-1	L 85 SL*	1/2 x 5/16"	12.70	22,000	17,800	0.50	0.70	7.75	11.30	11.80	16.90	18.50	8.51	4.45	-
10 B-1	M 106 SL*	5/8 x 3/8"	15.875	27,000	22,200	0.67	0.95	9.65	13.28	14.40	19.50	20.90	10.16	5.08	-
12 B-1	M 127 SL*	3/4 x 7/16"	19.05	32,700	28,900	0.89	1.25	11.75	15.62	16.40	22.70	23.60	12.07	5.72	-
12 A-1	M 128 A SL*	3/4 x 1/2"	19.05	42,000	31,300	1.06	1.47	12.70	17.75	18.09	25.44	27.99	11.91	5.96	-
Duplex															
08 B-2	D 85 SL*	1/2 x 5/16"	12.70	40,000	31,100	1.00	1.35	7.75	11.30	11.80	30.80	32.40	8.51	4.45	13.92
10 B-2	D 106 SL*	5/8 x 3/8"	15.875	56,000	44,500	1.34	1.85	9.65	13.28	14.40	36.00	37.50	10.16	5.08	16.59
Roller Chains, double-pitch type															
208 B	LR 165 SL*	1"	25.40	22,000	18,000	0.50	0.52	7.75	11.30	11.80	16.90	18.60	8.51	4.45	-
210 B	LR 206 SL*	1 1/4"	31.75	28,000	22,400	0.67	0.63	9.65	13.28	15.10	19.50	20.80	10.16	5.08	-
212 B	LR 247 SL*	1 1/2"	38.10	34,000	29,000	0.89	0.85	11.75	15.62	16.10	22.70	24.10	12.07	5.72	-

* Roller chain with "easy break" pins for trouble-free dismantling