



Hollow pin chain 10B-1 - ELITE

Part no.: 81013460

Packaging Unit: 5m

Brand: ELITE

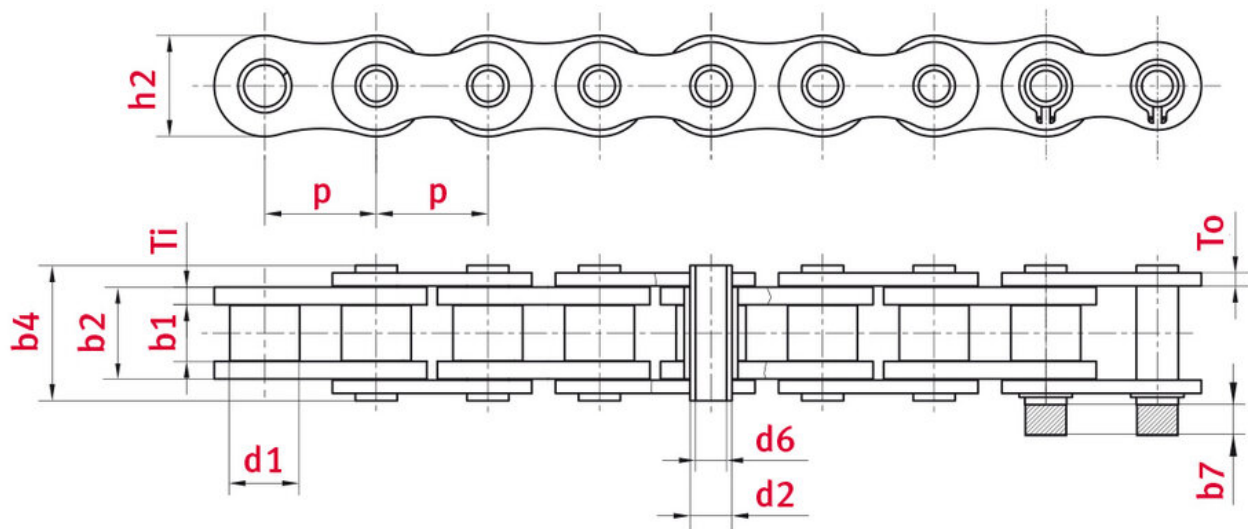

Technical data

ROLLER CHAIN	10B
Pitch p (mm)	15,875
Width between inner plates b1 min. (mm)	9,65
Roller diameter d1 max. (mm)	10,16

Pin diameter d2 max. (mm)	5,94
Pin length b4 max. (mm)	19,3
Hollow pin inner diameter d6 min. (mm)	4,1
Max. add. length of connecting link b7 max. (mm)	1,6
Total width inner link b2 max. (mm)	13,2
Plate thickness Ti/To (mm)	1,7
Height inner plate h2 max. (mm) (JWIS: g)	14,7
Min. tensile strength ISO/DIN FU (kN)	17
Weight per meter (kg)	0,86
Bearing surface f (cm ²)	0,78

Product Information

Hollow pin roller chains feature links of similar design to those in ISO roller chains; as they also consist of pin, bush and small roller, most hollow pin chains of this type also fit the same sprockets as the corresponding standard specification chains.

ELITE highlights

- Available based on the same chains manufactured to ISO 606 or as special chains
- All ELITE chain plates are manufactured using processes such as fine blanking and ball-drifting, so a particularly high contact ratio is guaranteed
- Solid, case hardened rollers with good wear resistance
- In general, hollow pins made of seamless precision steel tube for improved precision and wear resistance
- Many of these chains are supplied pair-matched to ensure exact parallel running, one of the main requirements that these chains must fulfil

Applications

- Conveyor technology
- Food processing industry
- Measurement and testing technology
- Feeding and automation technology



REQUEST DIRECTLY ONLINE NOW

<https://www.iwis.com/en-en/products-services/hollow-pin-chain-10b-1-elite~p3511>

Useful information



CALCULATION PROGRAM

InduKet: the Chain Drive
Calculation Program for
Engineers.

[iwis.com/chaincalc](https://www.iwis.com/chaincalc)



CHAIN CALCULATION

The right drive solution for your
challenge.

chaindrive@iwis.com



SERVICES

ChainFinder, CAD data, iwis
Chain Handbook and more.

[iwis.com/services](https://www.iwis.com/services)