



## Roller chain 10B-1 Straight side plates, Stainless steel - ELITE

Part no.: I409c36e4b1a2

Packaging Unit: 5m

Brand: ELITE

Model: Straight side plates

Surface: Stainless steel

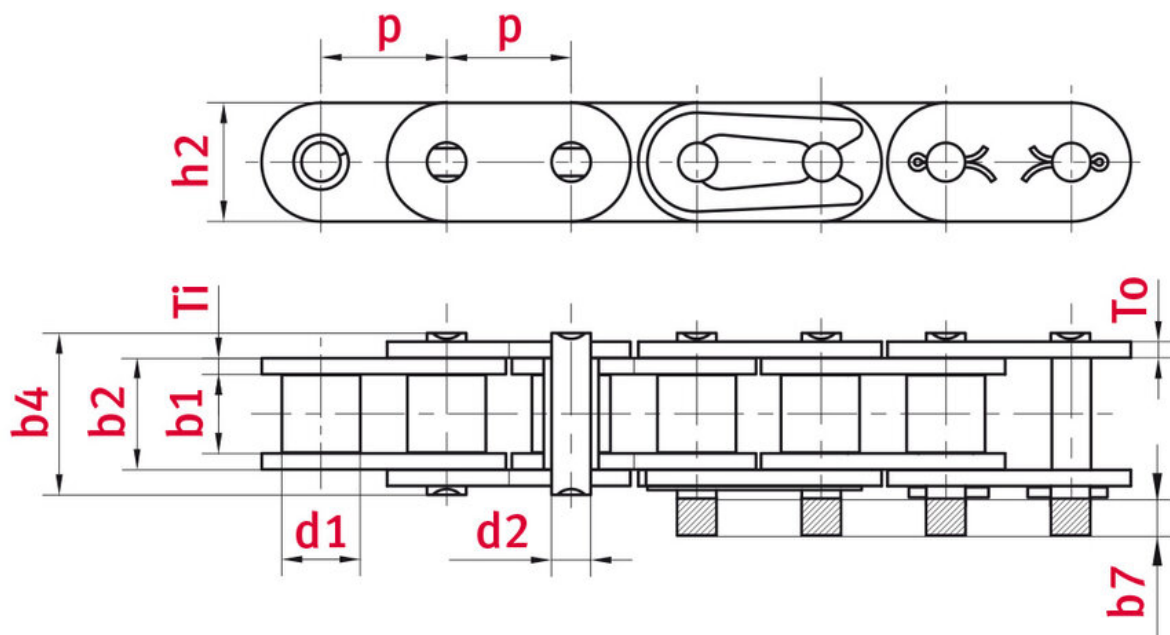

## Technical data

| ROLLER CHAIN                               | 10B    |
|--|--------|
| Pitch $p$ (mm)                             | 15,875 |
| Width between inner plates $b_1$ min. (mm) | 9,65   |
| Roller diameter $d_1$ max. (mm)            | 10,16  |

|  |           |
|--|-----------|
| Pin diameter d2 max. (mm)                        | 5,08      |
| Pin length b4 max. (mm)                          | 19,6      |
| Max. add. length of connecting link b7 max. (mm) | 4,1       |
| Plate thickness Ti/To (mm)                       | 1,70/1,70 |
| Height inner plate h2 max. (mm) (JWIS: g)        | 14,73     |
| Min. tensile strength ISO/DIN FU (kN)            | 14,5      |
| Weight per meter (kg)                            | 1,06      |
| Bearing surface f (cm²)                          | 0,67      |

## Product Information

Stainless steel chains are used mainly in the food and beverage industry or for applications in which chains require regular cleaning. The materials used in ELITE chains enable them to be used in acidic or alkaline environments. Always ensure that the chemicals in cleaning agents used are compatible with stainless steel material number 1.4301. The permitted tensile load for stainless steel chains is approximately one-third of the permitted load for comparable standard ELITE chains.

### Product highlights

- The dimensions of all ELITE stainless steel chains comply with the requirements of ISO 606 and the chains are interchangeable with standard chains
- Material for all chain components is 1.4301 / AISI 304
- All ELITE stainless steel chains are prestretched to 30 % of breaking load
- Chains are fitted with seamless rollers
- ELITE stainless steel chains feature cold-hardened pins and bushes, so they offer better wear resistance than other standard chains on the market
- Stainless steel chains do not lose performance as quickly as standard chains at high ambient temperatures
- Depending on their size, stainless steel chains are supplied lightly oiled or dry

## Applications

- Food processing industry
- Packaging industry
- Solar and energy technology



### REQUEST DIRECTLY ONLINE NOW

<https://www.iwis.com/en-en/products-services/roller-chain-10b-1-straight-side-plates-stainless-steel-elite~p3933>

## Useful information



### CALCULATION PROGRAM

InduKet: the Chain Drive  
Calculation Program for  
Engineers.

[iwis.com/chaincalc](https://www.iwis.com/chaincalc)



### CHAIN CALCULATION

The right drive solution for your  
challenge.

[chaindrive@iwis.com](mailto:chaindrive@iwis.com)



### SERVICES

ChainFinder, CAD data, iwis  
Chain Handbook and more.

[iwis.com/services](https://www.iwis.com/services)