

Sprocket with taper-lock bush 08B-2 17 teeth

Part no.: 81006725

Model: 17 teeth

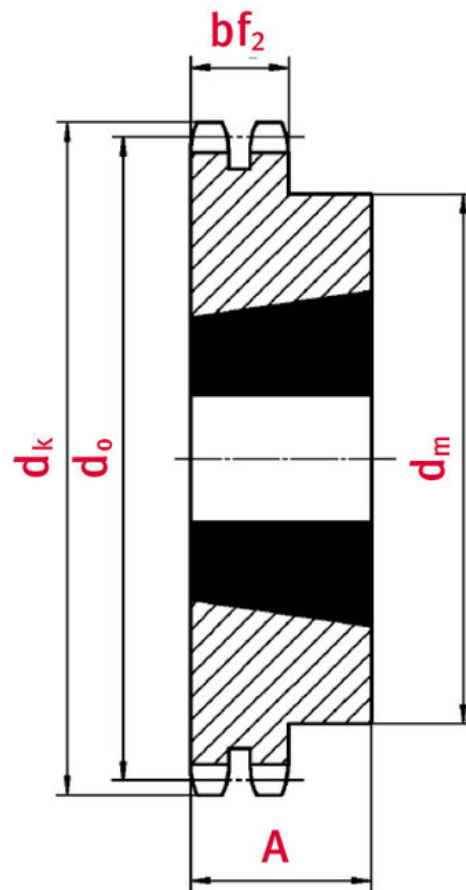

Technical data

SPROCKET	08B
Teeth	17
Tooth width duplex bf2 (mm)	21
Tip circle dk (mm)	74,5

Total length L (mm)	25
Hub	56
Taper-lock bush (Ref.-Nr.)	1210
Sprocket type	2

Product Information

Taper-lock clamping hubs enable the precise axially-centred fixing of hubs on shafts. When used with sprockets, they offer a twofold advantage over a shaft-to-hub connection with keyways: quick fitting and better centring.

REQUEST DIRECTLY ONLINE NOW

<https://www.iwis.com/en-en/products-services/sprocket-with-taper-lock-bush-08b-2-17-teeth~p6884>

Useful information

CALCULATION PROGRAM

InduKet: the Chain Drive
Calculation Program for
Engineers.

[iwis.com/chaincalc](https://www.iwis.com/chaincalc)

CHAIN CALCULATION

The right drive solution for your
challenge.

chaindrive@iwis.com

SERVICES

ChainFinder, CAD data, iwis
Chain Handbook and more.

[iwis.com/services](https://www.iwis.com/services)