

Plate Top Chain 843 Series 843, hardened carbon steel - FLEXON

Part no.: 34369

Packaging Unit: 3,048m

Brand: FLEXON

Model: Series 843

Surface: hardened carbon steel

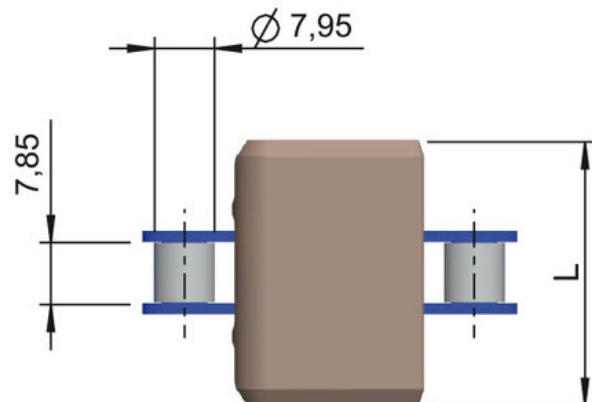
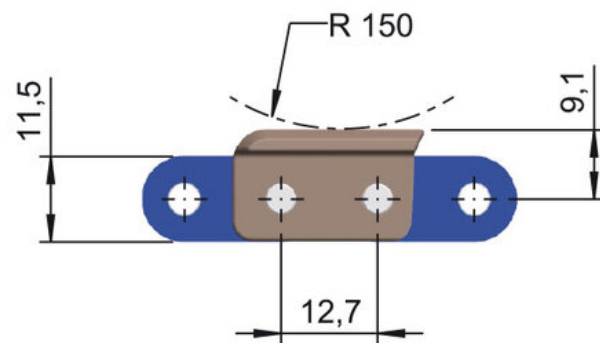
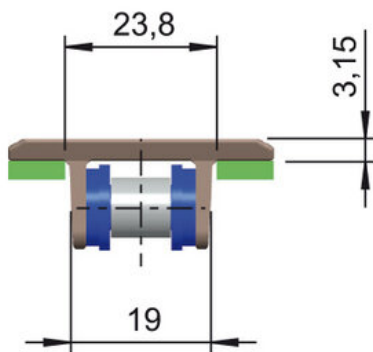

Technical data

| FLAT TOP CHAIN | 843 |
|-----------------------|------|
| Weight per meter (kg) | 0,89 |
| Back flex radius (mm) | 150 |
| Width L (mm) | 50,8 |

| | |
|---------------------------|------|
| Average breaking load (N) | 13,8 |
| Snap on material | LF |
| Material base chain | C45 |
| Pitch base chain (mm) | 12,7 |

Product Information

The FLEXON range of Plate Top chains are two piece assemblies of base roller chain, in steel or stainless steel, onto which a plastic plate is mounted. The combination of the two elements creates a chain with high breaking load provided by the ELITE base chain plus the benefit of a very flat top surface.

Top plates ready assembled on carbon steel base chain.

Highlights:

- ANSI 40 base chain with extended pins
- Easy to change out the snapped on top plates

Applications

- Feeding and automation technology
- Food processing industry
- Automotive industry



REQUEST DIRECTLY ONLINE NOW

<https://www.iwis.com/en-en/products-services/plate-top-chain-843-series-843-hardened-carbon-steel-flexon~p7244>

Useful information



CALCULATION PROGRAM

InduKet: the Chain Drive
Calculation Program for
Engineers.

[**iwis.com/chaincalc**](https://www.iwis.com/chaincalc)



CHAIN CALCULATION

The right drive solution for your
challenge.

[**chaindrive@iwis.com**](mailto:chaindrive@iwis.com)



SERVICES

ChainFinder, CAD data, iwis
Chain Handbook and more.

[**iwis.com/services**](https://www.iwis.com/services)