

## Case Conveyor Chain 600 Series CC600, Plastic - FLEXON

Part no.: 81014057  
Packaging Unit: 3,048m

Brand: FLEXON  
Model: Series CC600  
Surface: Plastic

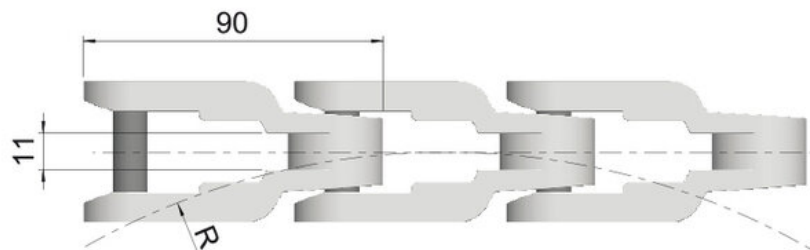
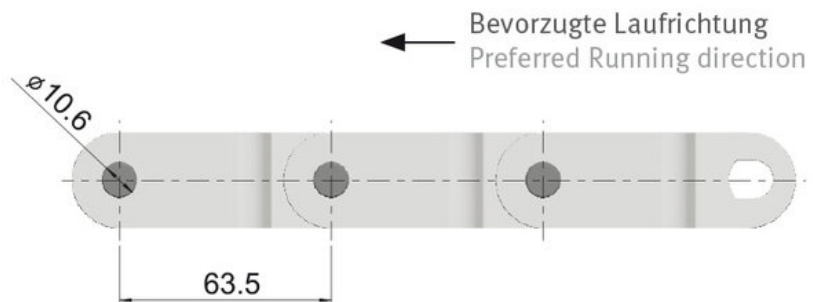
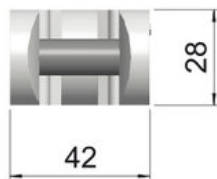

## Technical data

FLAT TOP CHAIN	600
Pin diameter d2 max. (mm)	10,6
Weight per meter (kg)	1,36
Chain material	POM

Pin material	Stainless steel
Average yield load (N)	14000

## Product Information

Case conveyor chains are suitable for many applications with harsh environmental conditions. They are available in plastic, steel or stainless steel. You can rely on the cast steel chain C600 to deal with the toughest traction applications and move the heaviest loads. The chain's simple yet robust cast steel design makes it an economical and highly resilient partner for the most rugged conditions and over long distances.

Highlights:

- Case conveyor chain for food industry, washing machines
- Reversible operation possible
- Special materials available on request (minimum order quantities)

## Applications

- Conveyor technology

**REQUEST DIRECTLY ONLINE NOW**

<https://www.iwis.com/en-en/products-services/case-conveyor-chain-600-series-cc600-plastic-flexon~p9500>

## Useful information

### **CALCULATION PROGRAM**

InduKet: the Chain Drive Calculation Program for Engineers.

[iwis.com/chaincalc](https://www.iwis.com/chaincalc)

### **CHAIN CALCULATION**

The right drive solution for your challenge.

[chaindrive@iwis.com](mailto:chaindrive@iwis.com)

### **SERVICES**

ChainFinder, CAD data, iwis Chain Handbook and more.

[iwis.com/services](https://www.iwis.com/services)